

PC Classroom One Page Setup

Connecting an Output Device

**Connecting a device via HDMI OR VGA requires using the HDMI/VGA connector located in the front of the classroom. **



HDMI/VGA Connections

- Connect the HDMI cable from the wall to the HDMI port on your device
OR connect the VGA cable from the wall to the VGA port on your device.
- Power on the laptop, log on, and share/mirror screen on your device.

Starting the Crestron Touch Panel Display with Source (VGA/HDMI)

- On the Crestron Touch Panel, touch the screen to start.
"A/V System Starting Please Wait" will appear on the touch panel.

**At this time, the projector will come into focus. **

- Select HDMI or VGA as the source to be displayed.

**At this time, your device will be displayed. **



Using the Crestron Touch Panel

Blanking/Unblinking the projector

- To blank the projector, select "Press Blank Projector."
The "Press To Blank Projector" button will now turn **blue**.
- To Unblank the projector, select "Press To Unblank Projector."

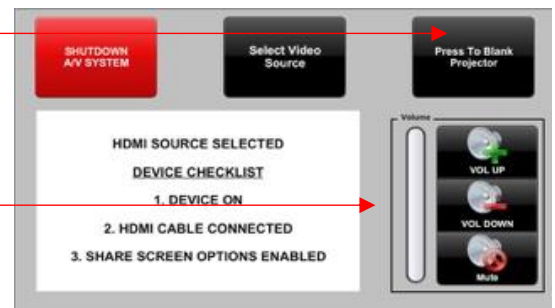

Raising and lowering the Volume

**First, ensure the volume level on your device is unmuted. **

- To raise the volume, select "VOL UP."
- To lower the volume, select "VOL DOWN."
- To mute, select "MUTE."
 - The "MUTE" button will now turn **blue**.
- To unmute, select the "MUTE" button.
 - The "MUTE" button will now turn back to the original color.

Shutting down the A/V System

- To shutdown the A/V system, select "SHUTDOWN A/V SYSTEM."
"Are you sure you want to shutdown the A/V System" will now be displayed.
- To continue shutdown, select "YES, SHUTDOWN A/V SYSTEM."
"Shutting down A/V system will appear" and the projector will shut off.
- To cancel shutdown, select "NO, CANCEL A/V SYSTEM SHUTDOWN."



MAC Classroom One Page Setup

Connecting an Output Device

* Connecting a device via MAC requires using the HDMI/ VGA connector located in the front of the classroom, along with bringing your **own** Apple HDMI/VGA connector. *



Apple
HDMI/VGA
connector

HDMI/VGA Connections

- Connect either HDMI **OR** VGA cable on the wall to the HDMI **OR** VGA Apple Adapter to your device.
- Power on your device, sign in, and share/mirror screen.

Starting the Crestron Touch Panel Display with Source (VGA/HDMI)

- On the Crestron Touch Panel, touch the screen to start. "A/V System Starting Please Wait" will appear on the touch panel.

*At this time, the projector will come into focus. *

- Select HDMI or VGA as the source to be displayed.

*At this time, your device will be displayed. *



Using the Crestron Touch Panel

Blanking/Unblinking the projector

- To blank the projector, select "Press Blank Projector."
The "Press To Blank Projector" button will now turn **blue**.
- To Unblank the projector, select "Press To Unblank Projector."

Raising and lowering the Volume

*First, ensure the volume level on your device is unmuted. *

- To raise the volume, select "VOL UP."
- To lower the volume, select "VOL DOWN."
- To mute, select "MUTE."
 - The "MUTE" button will now turn **blue**.
- To unmute, select the "MUTE" button.
 - The "MUTE" button will now turn back to the original color.

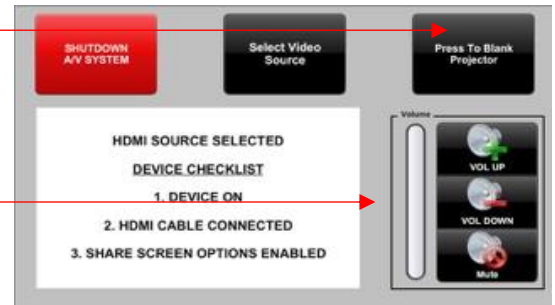

Shutting down the A/V System

- To shutdown the A/V system, select "SHUTDOWN A/V SYSTEM."
"Are you sure you want to shutdown the A/V System" will now be displayed.
- To continue shutdown, select "YES, SHUTDOWN A/V SYSTEM."
"Shutting down A/V system will appear" and the projector will shut off.
- To cancel shutdown, select "NO, CANCEL A/V SYSTEM SHUTDOWN."

